

GREENLAWN VALVE OPERATING INSTRUCTIONS

IMPORTANT READ PRIOR TO INSTALLATION



USE NO TOOLS

1. Plastic pipe threads can be damaged by over-tightening on metal fittings. To avoid this, tighten the valve by hand until tight; use a wrench only if necessary to orient the valve properly.
- 2. If you use a wrench for final positioning, do not tighten more than one full turn with a wrench.



USE TEFLON TAPE

1. Lay end of tape on male threads. Hold down with thumb, wrap tape around threads once, stretching tightly so threads show through tape.

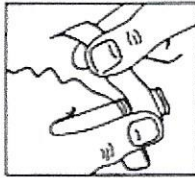

FLUSH LINES PRIOR TO INSTALLATION

1. Be sure to flush all pipelines prior to installing Greenlawn valves. This is to clean the system of any dirt, sand, etc which may clog the valve mechanism

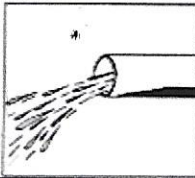

HELP!

**If You Have Problems or Need
Help With Our Equipment Call
Toll Free: (800) 873-7336
From 9:00am to 5:00pm Mt Time
If Busy or Calling from Colorado
(719) 495-0057
info@greenlawnsprinkler.com**

TROUBLE-SHOOTING PROBLEM:

THE VALVE STAYS OPEN

NOTE: SHUT OFF WATER MAIN PRIOR TO INVESTIGATION

Recommended trouble-shooting sequence:
Disassemble the valve first

CHECK THE DIAPHRAGM FOR OBSTRUCTIONS.

1. After removing the valve bolts & cover, check the small hole in the diaphragm top for obstructions. Clean the hole using a paper clip or pin-like object to remove any debris.

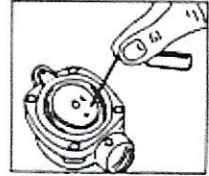

CHECK THE SOLENOID PLUNGER ASSEMBLY FOR OBSTRUCTIONS.

1. Remove the valve solenoid from the cover assembly by turning counter-clockwise.
2. Turn the solenoid upside-down and flush the plunger & plunger pocket out with water to remove the debris.
3. Reinstall the solenoid.

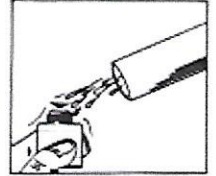

CHECK THE DIAPHRAGM FOR PERFORATIONS.

1. Remove the diaphragm & check it for tears, rips, etc. Replace diaphragm with new one if perforated (71-DS).
2. Check the valve body for stones, debris, etc. Remove such material.
3. Be sure to replace the diaphragm to its correct positioning by returning it with the side marked "top" facing the valve cover: (The valve cover holds the solenoid).

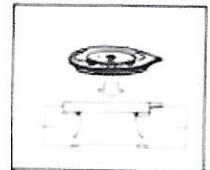

PROBLEM:

THE VALVE STAYS CLOSED

NOTE: SHUT OFF WATER MAIN PRIOR TO IN- VESTIGATION

1. Check the electrical connections & controller programming. If the controller is functioning correctly then follow this sequence of analysis:
2. Remove the solenoid from the valve in question. (It would be helpful to have an assistant to activate the controller zone, while another person observes the solenoid performance).
3. Hold the solenoid upside-down (wires down) so that you can observe the action of the plunger when energized.
4. Have your assistant activate the zone in question with the controller & observe the action of the plunger. Repeat this several times.
5. A properly operating solenoid will have a plunger which significantly retracts into the solenoid itself when energized. If the plunger does not retract it should be replaced. (71-1A).